

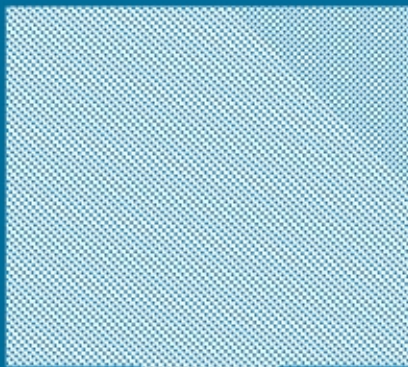

**TELESCOPIC
HYDRAULIC
SHOCK
ABSORBERS
TYPE TB & TEI**

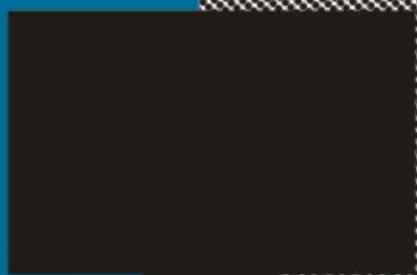

Telescopic Hydraulic Shock Absorbers

Type TB-100/140/190 & Type TE1-10A/70A

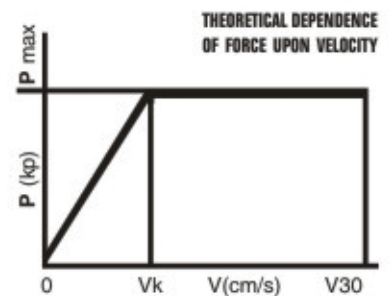
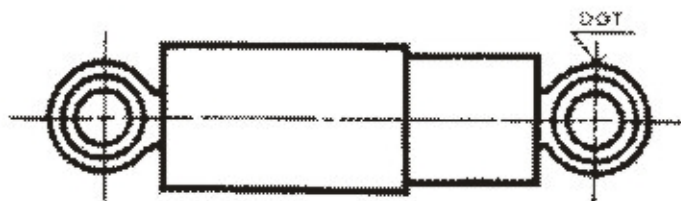
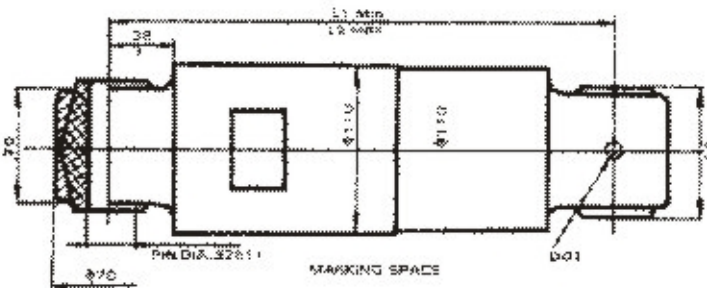
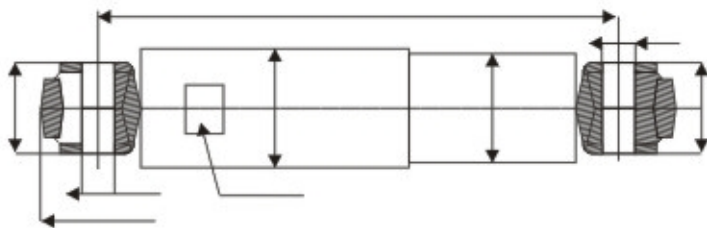

Telescopic Hydraulic Shock Absorbers

Type TB-100/140/190 & Type TE1-10A/70A

These Shock Absorbers Serve the Purpose of damping the vibrations of sprung masse. It works in any-from vertical to horizontal-position. The absorber is out door temperatures from - 40 to + 60 deg. C. Damping force increases in proportion to the velocity of piston rod travel up to critical velocity / vk / Beyond this velocity, up to 30 cm. p. Sec., the force does not practically increase.

The course and extent of damping during compression or elongation of the shock absorber must be selected within the typification indicated in Table I from which, for the selected max. force / Pmax. / and critical velocity / vk / the damping constant / $K = Pmax./vk/$ is derived, which constant is then a part of shock absorber marking.

The shock absorber stroke is selected according to Table II.

The Shock absorber is marked by a system of figures and digits, representing its properties.

An example of marking

TB 190.63.50

TB - Basic marking

190 - stroke in mm / Table II /

63 - damping constant for shock absorber elongation / Table I /

50 - damping constant for shock absorber compression - Table I /

The Marking Composed in this way must be stated in the order.

Remark : we reserve the right of changes in dimensions and of basic technical values.

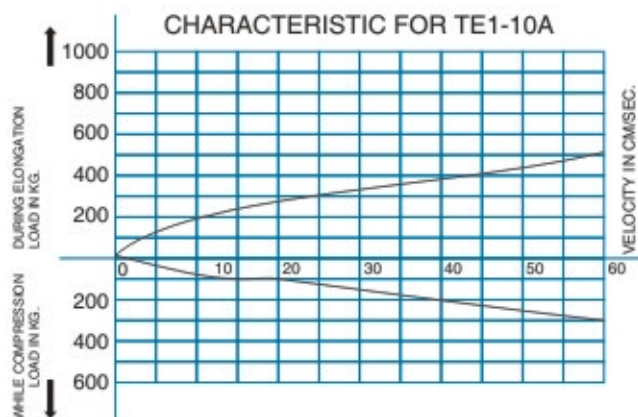

Table I

Max. Force Pmax kp	CONSTANTS for vk		
	10cm p.sec.	16cm p.sec.	20cm p.sec.
	kp.sec.cm-1	kp.sec.cm-1	kp.sec.cm-1
200	20		10
320	32		16
500	50		25
800	80		40
1260	126		63
1600	160	100	

Table II

TABLE OF STROKES AND LENGTHS				
Stroke	L1	L2	Weight	Liquid
mm	mm	mm	kp	cu. cm
100	270	370	9	578
140	310	450	10.5	754
190	360	550	13	974

Telescopic Hydraulic Shock Absorbers

**Type TB-100/140/190 &
Type TE1-10A/70A**

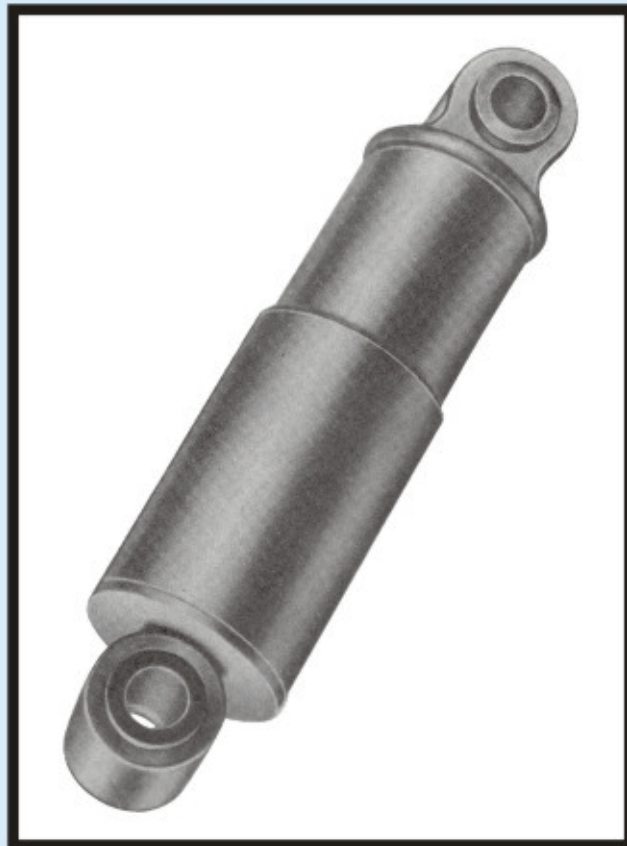

K. S. DIESELS LTD.

Aji GIDC Area, Rajkot - 360 003.

Phone : 0281 - 2387381 - 82 - 83 **Fax** : 0281-2387407

E-mail : info@ksdiesels.com **Website** : www.ksdiesels.com